



**FEATURES**

- The intuitive helm is available with an optional 9" or 12" Simrad® touchscreen display to enhance the command experience.
- Premium Fusion® audio system with Bluetooth®, Wi-Fi audio streaming with Apple AirPlay® 2 & Digital Signal Processing (DSP).
- Interior head compartment with optional upgrade.
- Large bow & cockpit lounging floorplan with multiple convertible backrests.
- Optional Elite and Elite Plus packages available.

**EXTERIOR COLORS**



**STANDARD PROPULSION**

Mercury® 200 FourStroke Outboard  
(200 hp / 149 kW)



**FUEL CAPACITY**

63 gal / 238 L



**LENGTH OVERALL**

25'2" / 7.67 m  
with integral / extended swim platform



**LENGTH OVERALL**

27'6" / 8.38 m  
with outboard engine



**BEAM**

8'6" / 2.59 m



**DRAFT**

36" / 91 cm (outboard down)



**DRY WEIGHT**

5,557 lb / 2,521 kg



**DEADRISE**

21°



**WATER CAPACITY**

10 gal / 38 L (opt)



**CAPACITY**

14 people / 2,300 lb / 1,043 kg  
Maximum: 2,500 lb / 1,134 kg

*Specifications are approximations and subject to variance.*

## STANDARD FEATURES

### HULL & DECK FEATURES

- Bow & Stern Eyes, Stainless Steel
- Bow Locker: Integral Fiberglass Hatch with Stainless Steel Hardware; Concealed Four Step Bow Boarding Ladder & Anchor Storage – Foredeck
- Cleats, Thru-Bolted (6), 6" Stainless Steel with Sea Ray Logo
- Deck, Fuel Fill Plate – Stainless Steel
- Drain Plug, Brass-Threaded – Garboard
- Gel Coat, Arctic White
- Hardware, Stainless Steel
- Lights, Navigation – Stainless Steel
- Rub Rail, White PVC with Stainless Steel Insert
- Swim Platform with Undermount Stainless Steel Three-Step Swim Ladder
- Windshield, Black Matte Finish with Port Walk-Thru to Bow

### COCKPIT FEATURES

- Beverage Holders, Stainless Steel with Rubber Inserts
- Cockpit Vinyl Color: Ivory (White Base Vinyl with Brown Accent Vinyl)
- Cooler, Carry-On with Designated Storage
- Dash, Custom Upholstered Visor
- Door, Bow Block-Off – White Acrylic
- Door, Transom, Acrylic
- Floor, Finished Fiberglass
- Grab Handles, Stainless Steel
- Head Compartment: Enclosed with Fiberglass Lockable Door & Portable Head
- Lighting, Courtesy, White LED
- Outlet, 12V Accessory / USB
- Storage, Cockpit Floor with Vinyl Matting, Gas-Assisted Fiberglass Lid & Lockable Stainless Steel Latch
- Table, Cockpit with Designated Storage – Plastic
- Vinyl, Marine-Grade with Mildew & UV Protection

### SEATING

- Bow with Aft and Forward-Facing Seating
- Double Helm Seat with Reversible Backrest, Flip-Up Thigh Rise & Fiberglass Base
- Double Port Companion Seat with Reversible Backrest, Flip-Up Thigh Rise & Fiberglass Base
- Port L-Shaped Lounger & Storage
- Transom Sunpad with Reversible Backrest & Storage

### TECHNICAL FEATURES

#### HELM

- Alarms, Engine – Oil & Water (Audible)
- Horn
- Instrumentation, Custom Sea Ray® SmartCraft® Diagnostics
  - Bezels, Chrome
  - Gauge, Fuel
  - Gauge, Trim
  - Lenses, Glass
  - Lighting, Low-Glare – Blue
  - Speedometer
- System Tachometer with Digital Monitoring for Depth, Engine Alarms/Hours, Fuel Consumption/Usage, Oil Pressure, Trim Level & Voltage
- Mercury VesselView® Mobile
- Shift & Throttle Lever with Trim (Chrome Accented) Switch & Lanyard Stop Switch
- Steering, Power-Assisted Tilt Wheel
- Stereo, Fusion® SRX400 12V AM/FM
  - Bluetooth™
  - Digital Signal Processing (DSP)
  - Speakers (6.5") – 2 Pairs
  - Wi-Fi Audio Streaming with Apple AirPlay® 2
- Switch Panel with Weatherproof Lighted Chrome Toggle Switches, Backlit
- Tilt & Trim, Power

#### BILGE COMPARTMENT

- Bilge Pump, 12V Automatic
- Gel-Coated Compartment

### ELECTRICAL SYSTEMS

- Battery On/Off Switch, Dual with 2 Trays
- Fuse Block
- Wiring, Color-Coded with Chafe Protection

### FUEL SYSTEMS

- Evaporative Emissions Fuel System
- Fuel Lines, USCG – Type A-1
- Fuel Tank with Mechanical Shutoff & Electric Stainless Steel Sending Unit

### UNDERWATER GEAR

- Propellers, Stainless Steel

## OPTIONS & ACCESSORIES

### OPTIONAL PROPULSION

- Mercury 200 FourStroke Outboard – White (200 hp / 149 kW)
- Mercury 250 Verado® Outboard – Black (250 hp / 186 kW)
- Mercury 250 Verado Outboard – White (250 hp / 186 kW)
- Mercury 300 Verado Outboard – Black (300 hp / 224 kW)
- Mercury 300 Verado Outboard – White (300 hp / 224 kW)

### EXTERIOR COLOR

- Gel Coat, Full Hull (Non-Metallic Gels Only)
- Gel Coat, Hull Bottom – Arctic White or Onyx Black
- Gel Coat, Hull Side
- Gel Coat, Three Zone (Metallic Gels Available for Zone 2 or 3 Only)

### UPHOLSTERY, INTERIOR, SEATING & FLOORING

- Bow Filler Cushion
- Cockpit Table, Teak, with Dedicated Storage
- Cockpit Vinyl Color – Dune (Tan Base Vinyl with Brown Accent Vinyl)
- Cockpit Vinyl Color – Stone (Grey Base Vinyl with Dark Grey Accent Vinyl)
- Flooring Color: Brown or Grey

- Head Upgrade with Ventilation Window & Cushions
- SeaDek Swim Platform Matting (Glue Down)
- Snap-In Carpet – Bow & Cockpit
- Snap-In Infinity Woven Vinyl Flooring – Bow & Cockpit
- Snap-In SeaDek – Bow & Cockpit
- Table, Plastic – Bow with Dedicated Storage

### TOWERS & CANVAS

- Bimini Top & Boot with Stainless Steel Ball & Socket Hardware
- Canvas Color: Black, Marine Midnight Blue or Toast Tweed
- Canvas Package For Bimini Top
- Cockpit Cover with Tonneau Cover
- Full Forward Bimini Top & Boot (N/A with Optional Tower)
- Mooring Cover – Available in Black Only
- Watersports Tower, Manual with Integrated Bimini Top – Black or White

### ELECTRONICS

- Audio Upgrade, Premier – Fusion® Apollo RA770 12V AM/FM
  - NRX 300 Transom Remote
  - Signature Series 5-Channel Amplifier (1600W)
  - Signature Series Speakers (6.5") – 3 Pairs
  - Signature Series Subwoofer (10")
- Digital Dash (9") with Mercury® VesselView® Link
  - Active Trim (Automatic Engine Trim System)
  - Chartplotter with Preloaded Charts (North America Only)
  - Simrad® G09 (9") Touchscreen Display
  - Transducer with Depth, Water Temperature and Fishfinder
- Digital Dash (12") with Mercury® VesselView® Link
  - Active Trim (Automatic Engine Trim System)
  - Chartplotter with Preloaded Charts (North America Only)
  - Simrad® G012 (12") Touchscreen Display
  - Transducer with Depth, Water Temperature and Fishfinder

**ADDITIONAL OPTIONS**

- Air Compressor for Water Toys
- Bow & Transom Sprayer
- C E Option Group
- Docking Lights
- Fender Clips (6) – Quick Connect
- Flagpole with Base & US Flag
- Lighting, Underwater (Thru-Hull) – Blue or White
- Lighting Package, LED – Blue or White
- On Board Battery Charger – 120v/60 To 12v
- On Board Battery Charger – 220v/50 To 12v
- Premium PTM Ski Mirror
- Pump-Out Head
- Swivel Wakeboard Racks
- Tower Accent Panels
- Tower Speakers (Includes 2 Fusion<sup>®</sup> 8.8" Signature Series Can Speakers & 1400W Amp) (Only Available with Tower & Stereo Upgrade Options)

**TRAILER OPTIONS**

- Trailer, Tandem Axle with Tandem Axle Disc Brakes (Galvanized)
- Trailer, Tandem Axle with Tandem Axle Disc Brakes (Painted)

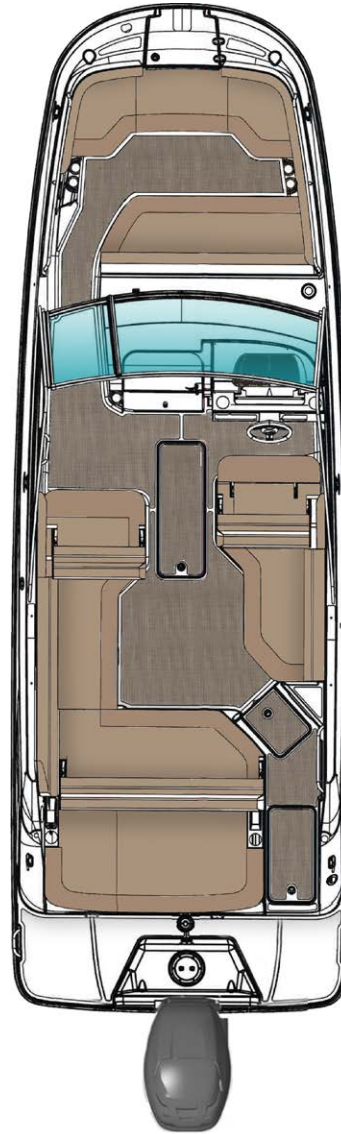

**STANDARD SEATING PLAN**

# 2021 PACKAGES

## SDX SERIES



	SDX 250	SDX 250 OB	SDX 270	SDX 270 OB	SDX 290	SDX 290 OB
Digital Dash™ (9") with Mercury® VesselView® Link	✓	✓	✓	✓	✓	Standard
Fender clips	✓	✓	✓	✓	✓	✓
Lighting package, LED	✓	✓	✓	✓	✓	✓
SeaDek® on swim platform	✓	✓	✓	✓	✓	✓
Swim platform with manual submersible step	✓		✓		✓	
Watersports tower with Bimini top	✓	✓	✓	✓	✓	✓



	SDX 250	SDX 250 OB	SDX 270	SDX 270 OB	SDX 290	SDX 290 OB
<b>Elite Package included</b>	✓	✓	✓	✓	✓	✓
Anchor, stainless steel (only with windlass)			✓	✓	✓	✓
Cushion, bow filler	✓	✓	✓	✓	✓	✓
Digital Dash™ (12") w/ Mercury® VesselView® Link	✓	✓	✓	✓	✓	✓
Head (interior upgrade)	✓	✓	✓	✓	✓	✓
Lighting, underwater (thru-hull)	✓	✓	✓	✓	✓	✓
Stereo upgrade, premier (spkr/subwoofer/amp)	✓	✓	✓	✓	✓	✓
Table, cockpit – teak	✓	✓	✓	✓	✓	✓
Windlass (rope/chain with galvanized anchor)			✓	✓	✓	✓